

Copper beech is my favourite.
Next door has a huge old one
at night its like a big
whispery shadow, and when
its windy it sounds so dramatic



more

of monsters
+ men-animal





W/W -



W

2 weeks



I'll sleep when I'm dead

Next week



I'm so lazy...

This problem is easily solved



balance your energy, bitch.



→



STOP CATASTROPHIZING

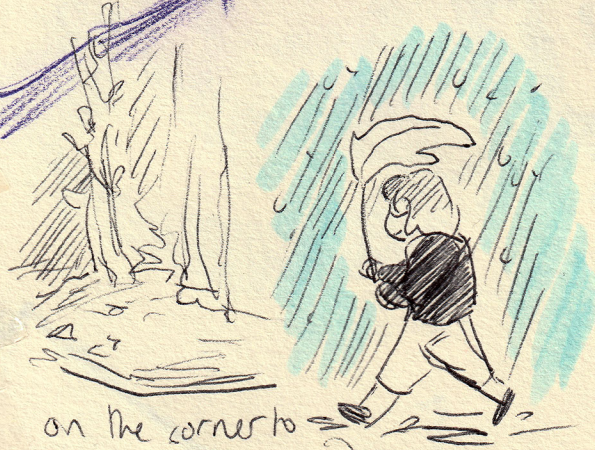

on the corner to the quarry

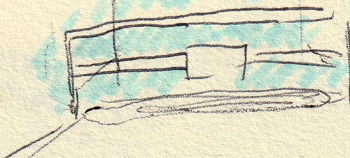

Go to bed, stupid

01:31

This one is Me Daler Rowney Ebony. The seawhites are shit!



V7 hitech paint
pilot



行

白

not waterproof

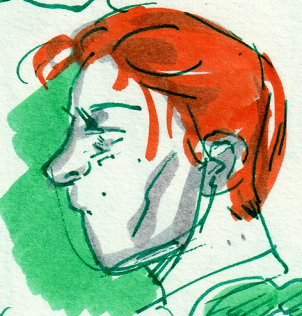

New glasses

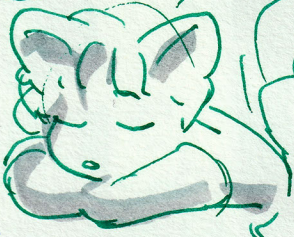

call me
Harry I
dare you



didnt
get a
bag

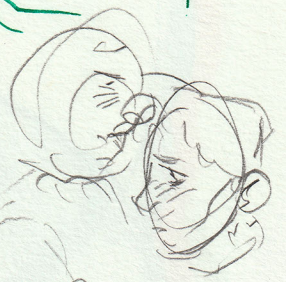
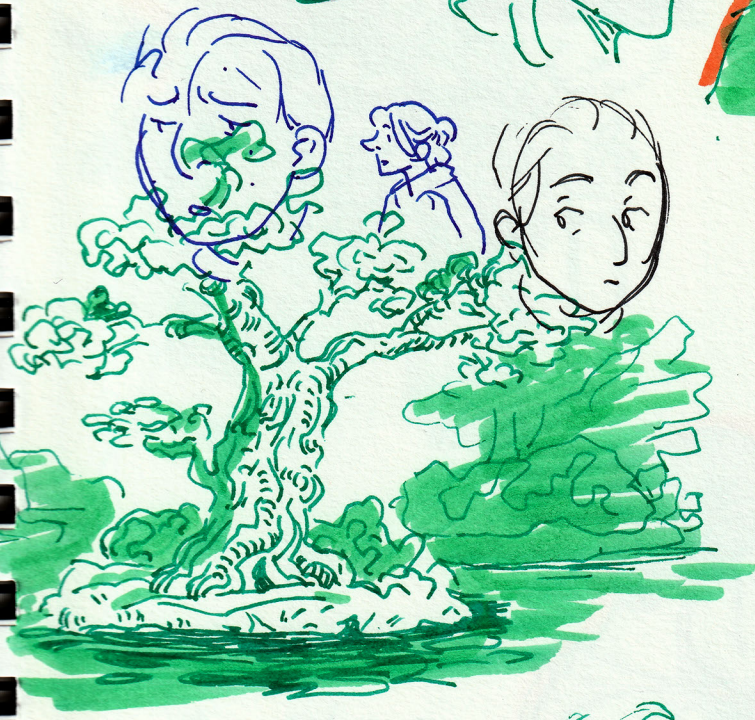

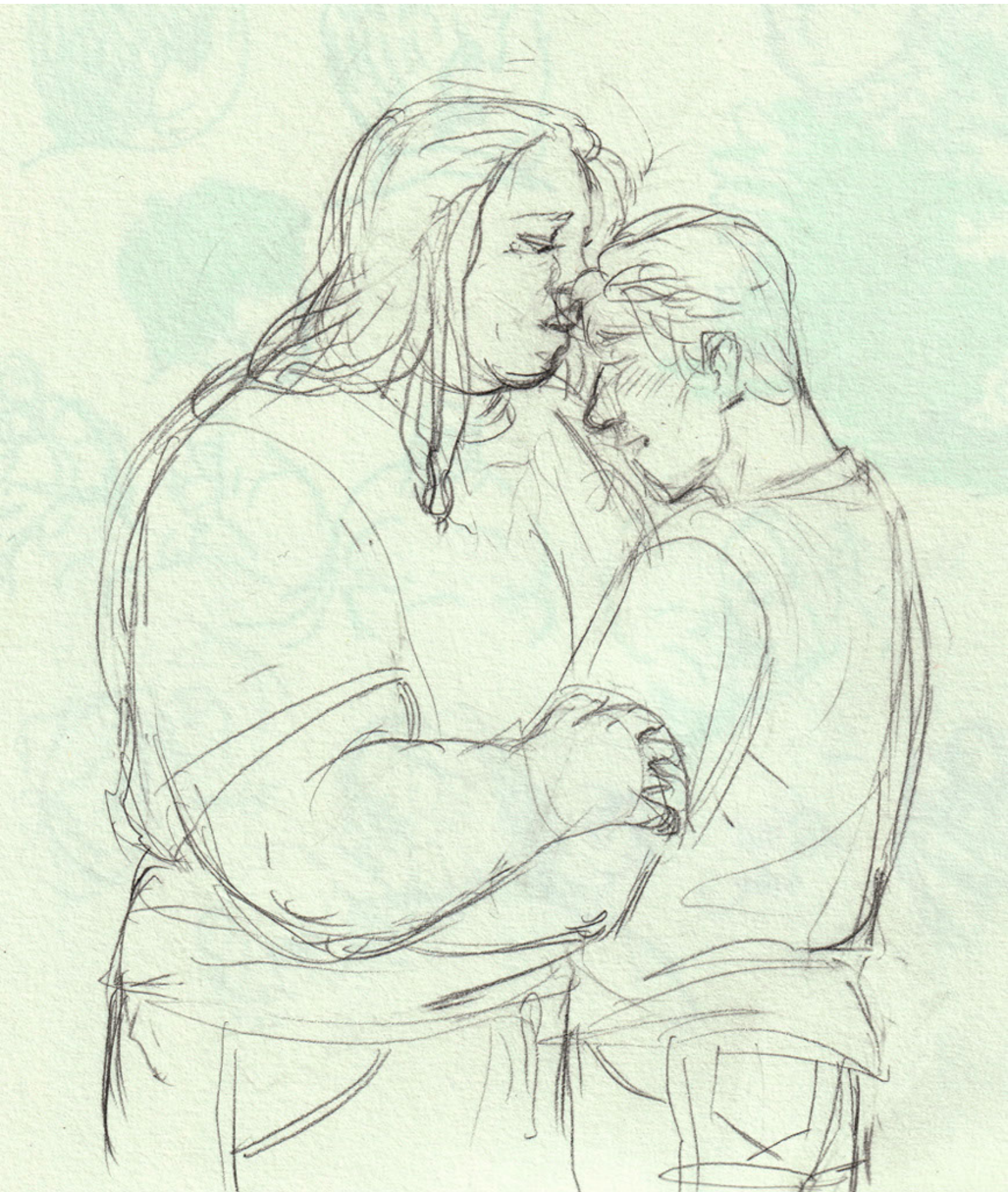



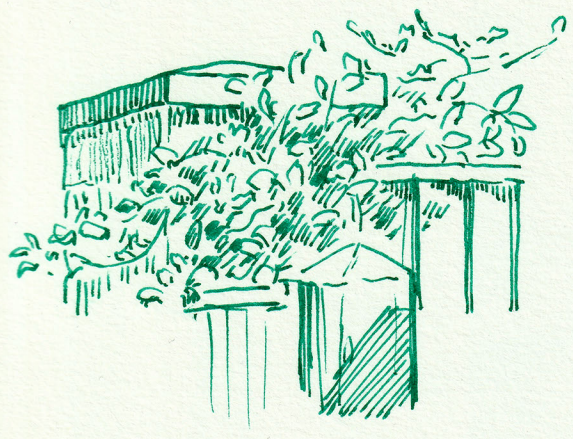
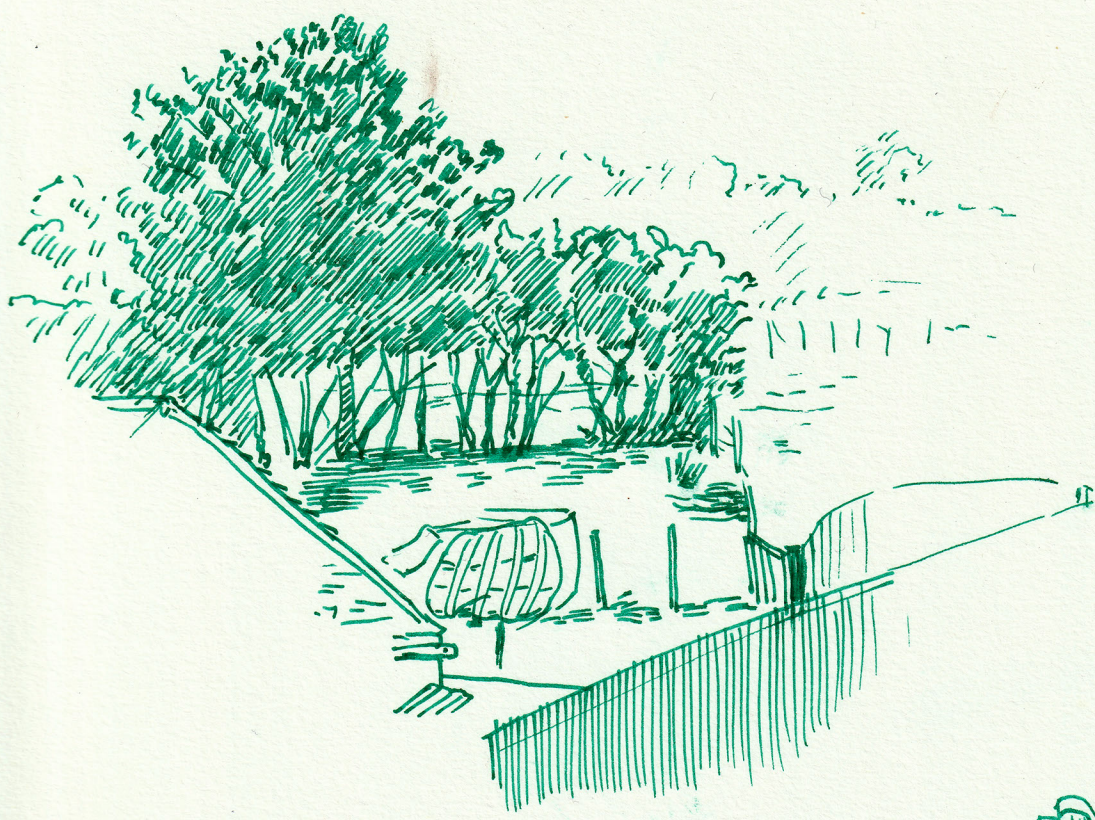



Why do you move so much?

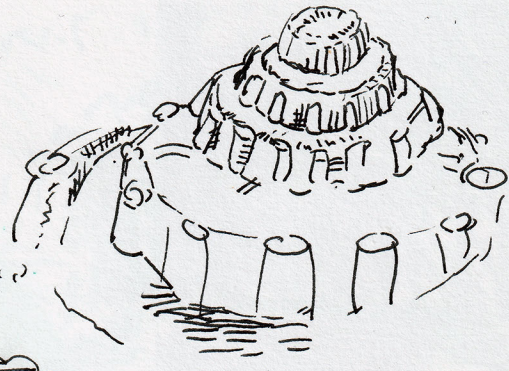

laputa copy

==...
||

so bad

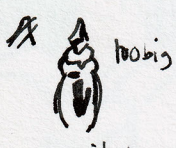

witch hot copy



X

Those folds are bad!

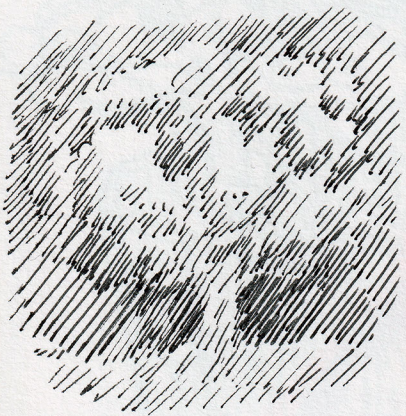
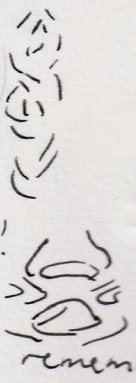



the line studies are from witch hat atelier



outside shop near buses



oak by church

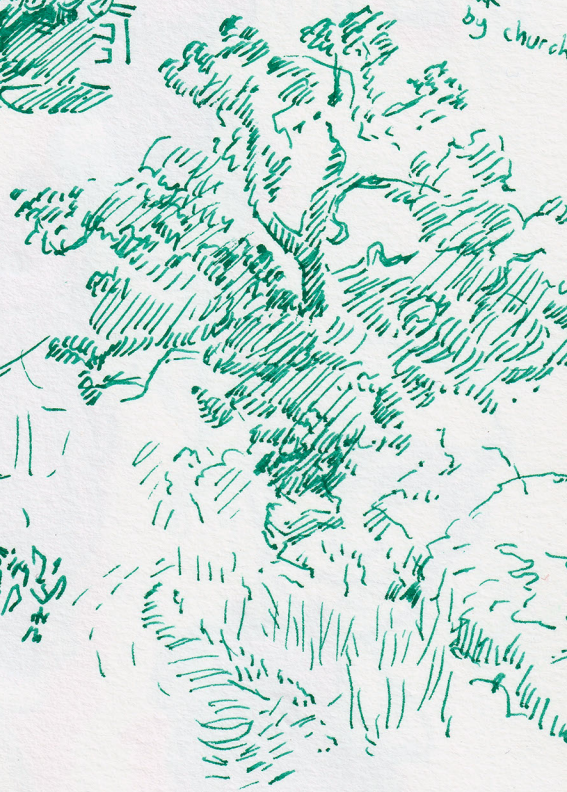

on the way up the hill pausing to rest

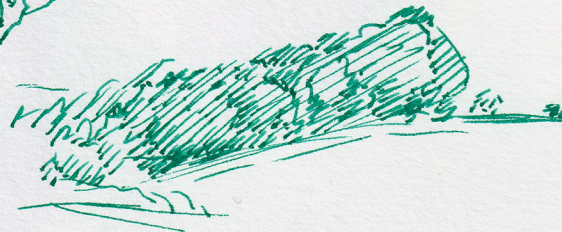

it feels like a vale

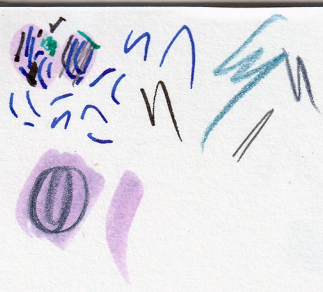

we parked in
Levening +
walked around a
bit. Got a free

night + the city
studies??

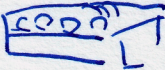
apple  

All the gardens were so nice

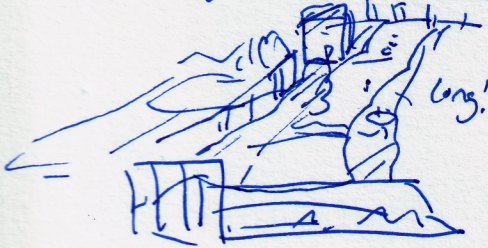

too small!

