

-The Hall of the Long Banner is a residential district of Brazen throne. With the exception of a few market stalls, all the buildings here are homes.

-Relative to the other residential areas in the city, the Hall of the Long Banner is fairly upscale, populated by many mid-level government officials and other educated citizens, most of whom work in the Great Hall.

-The Hall's titular banner, hanging at the end of the hall, is Brazen throne's "Banner of Ages," a long tapestry depicting major events in the city's history. As the name suggests, it is very long, measuring at over 45 feet in length. Because the banner is very heavy-- and very old-- the last ten feet now rest on the ground in order to keep it from tearing under its own weight.

-The version of this map without the market is intended for people using Brazen throne as an abandoned ruin, since it's hard to imagine market stalls surviving the ages.



THE HALL ^{OF} THE LONG BANNER

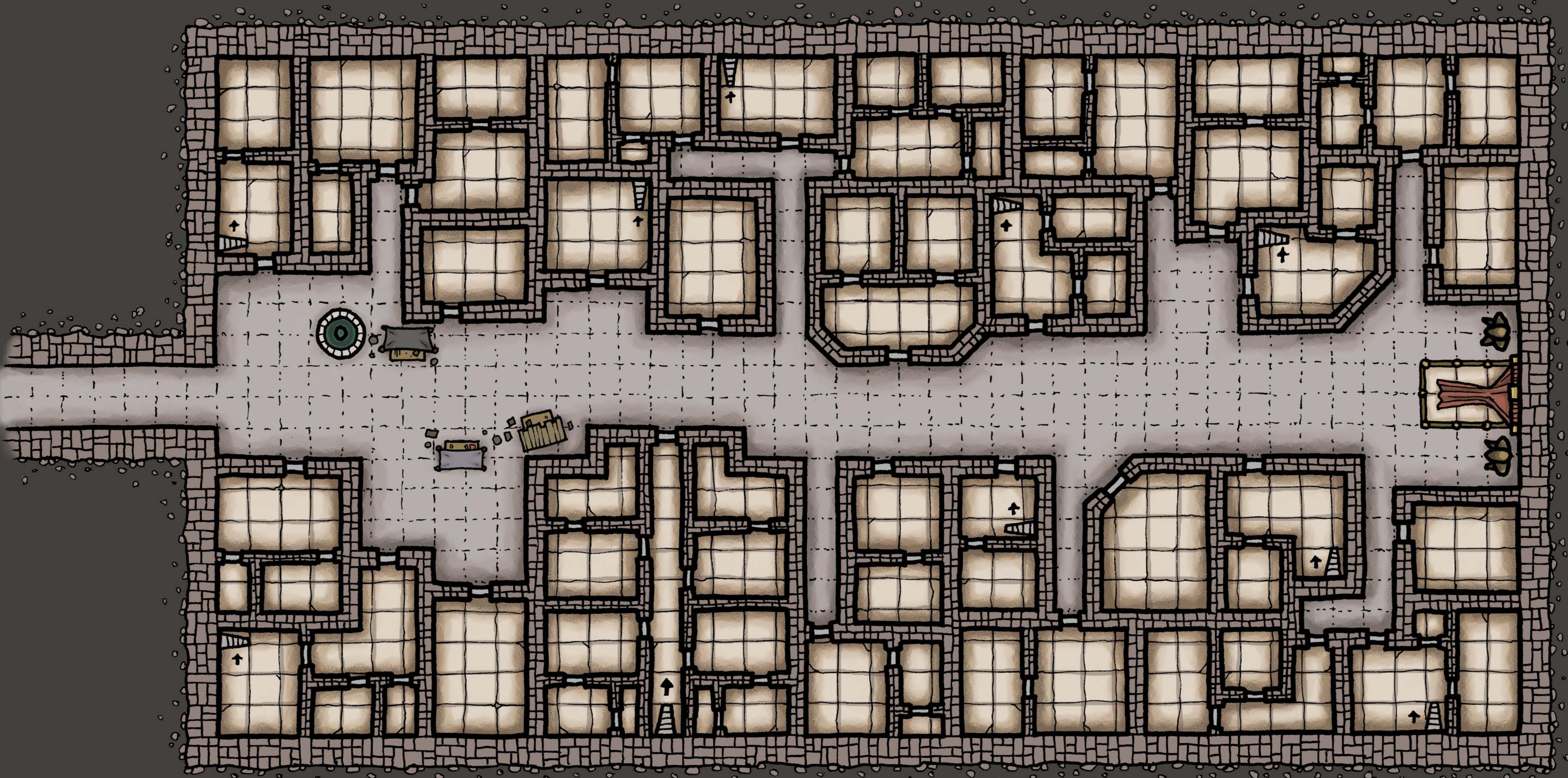
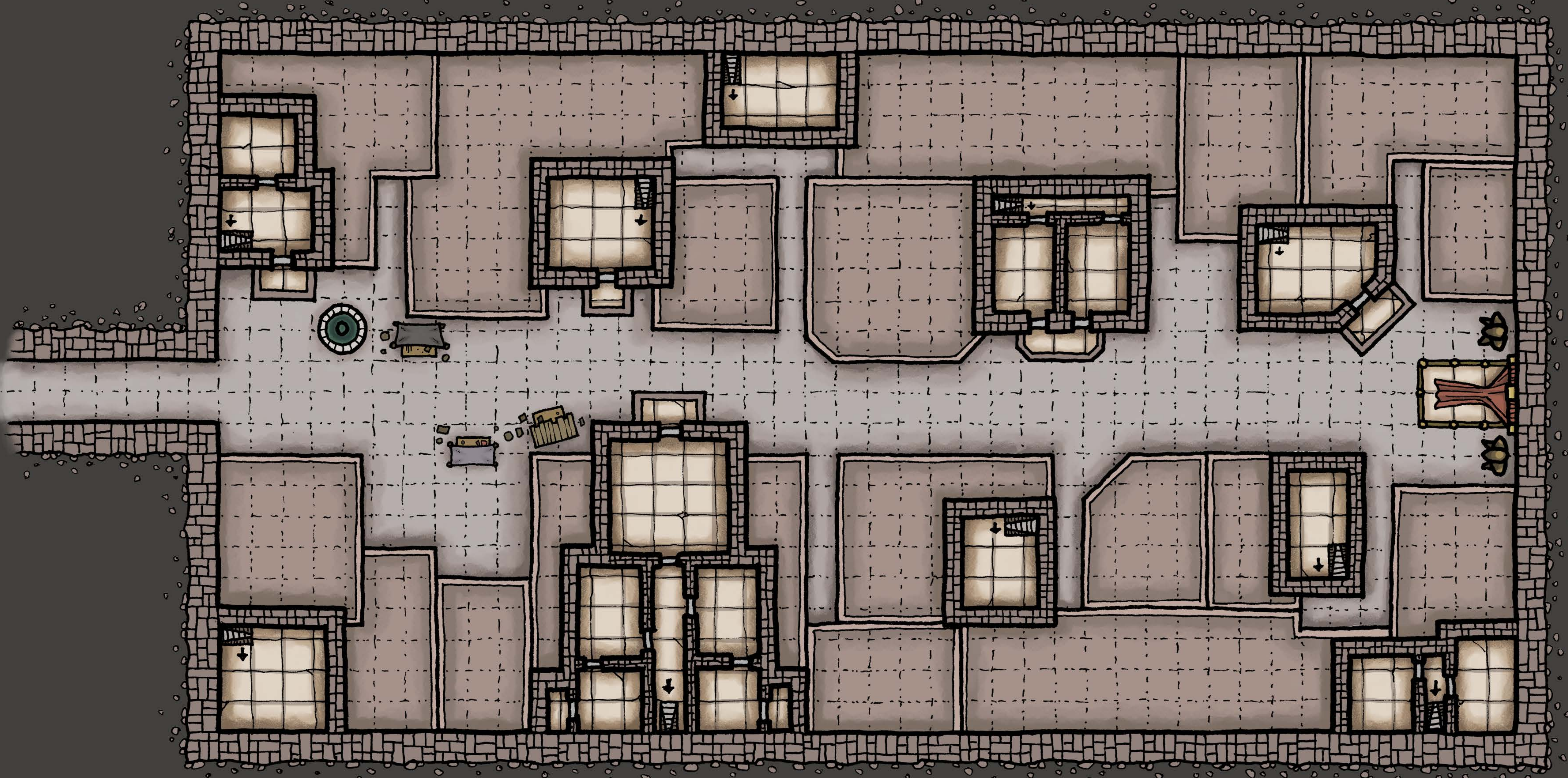

UPPER LEVEL

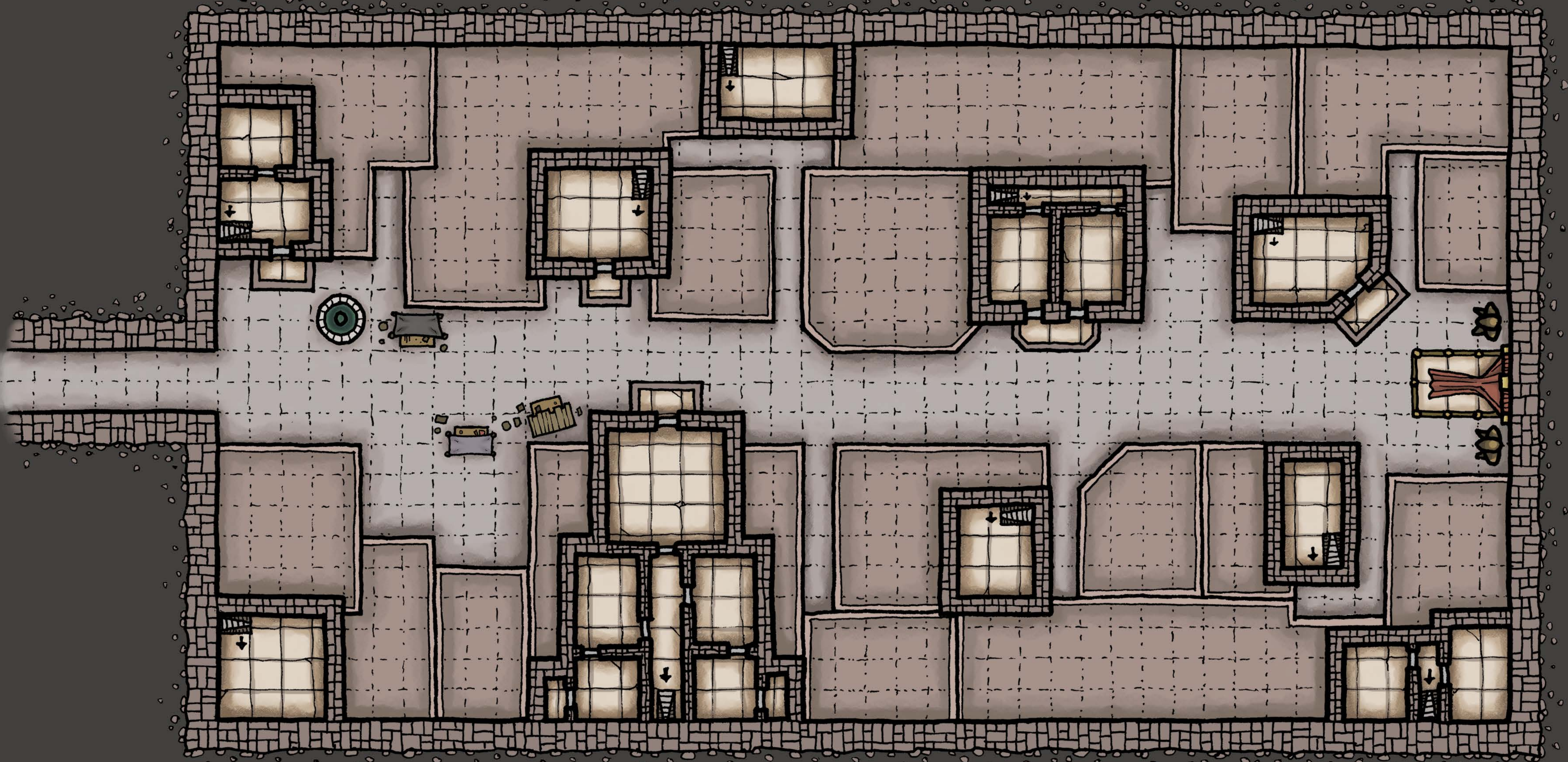

GROUND LEVEL

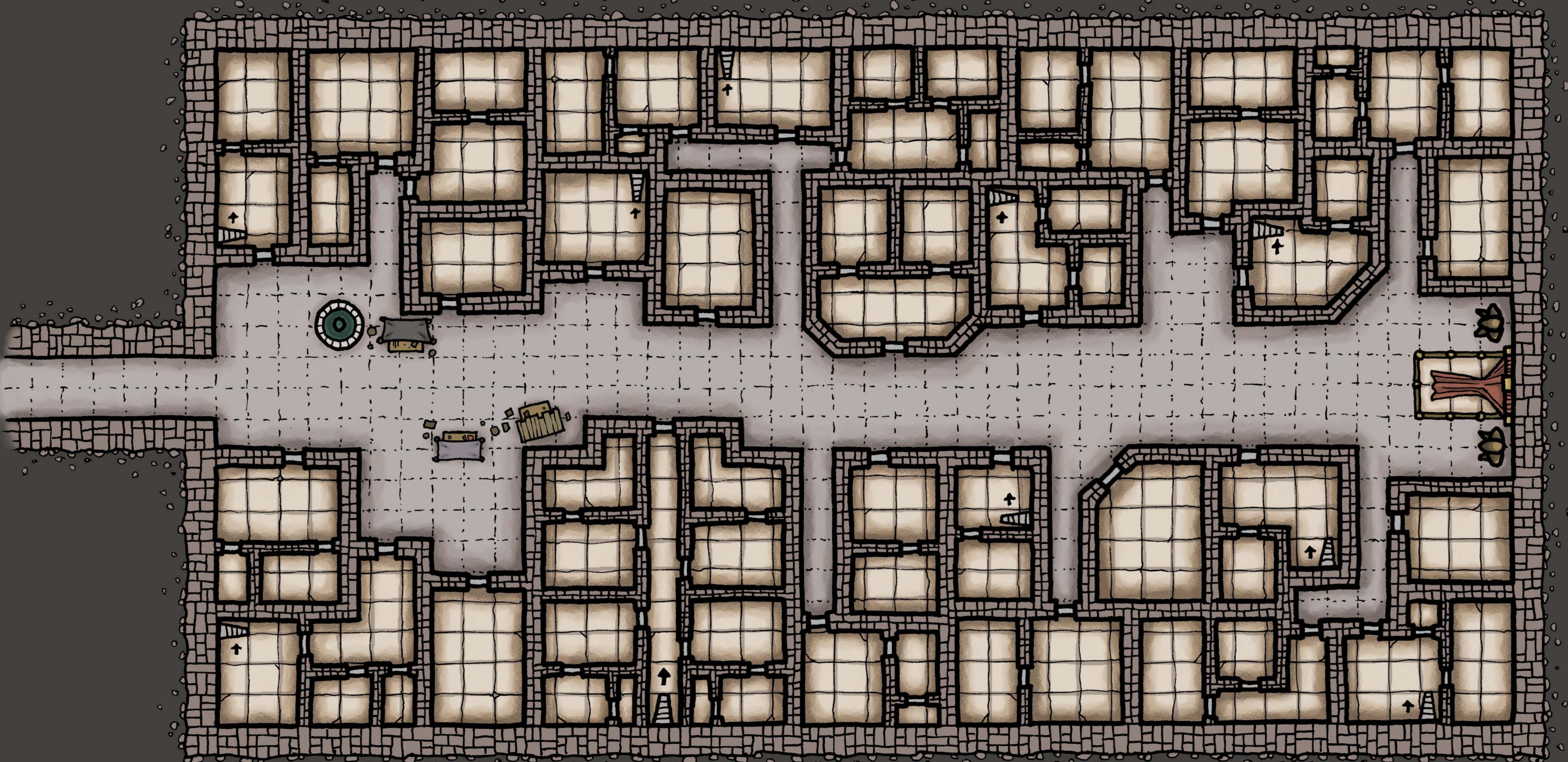

THE HALL OF THE LONG BANNER

UPPER LEVEL

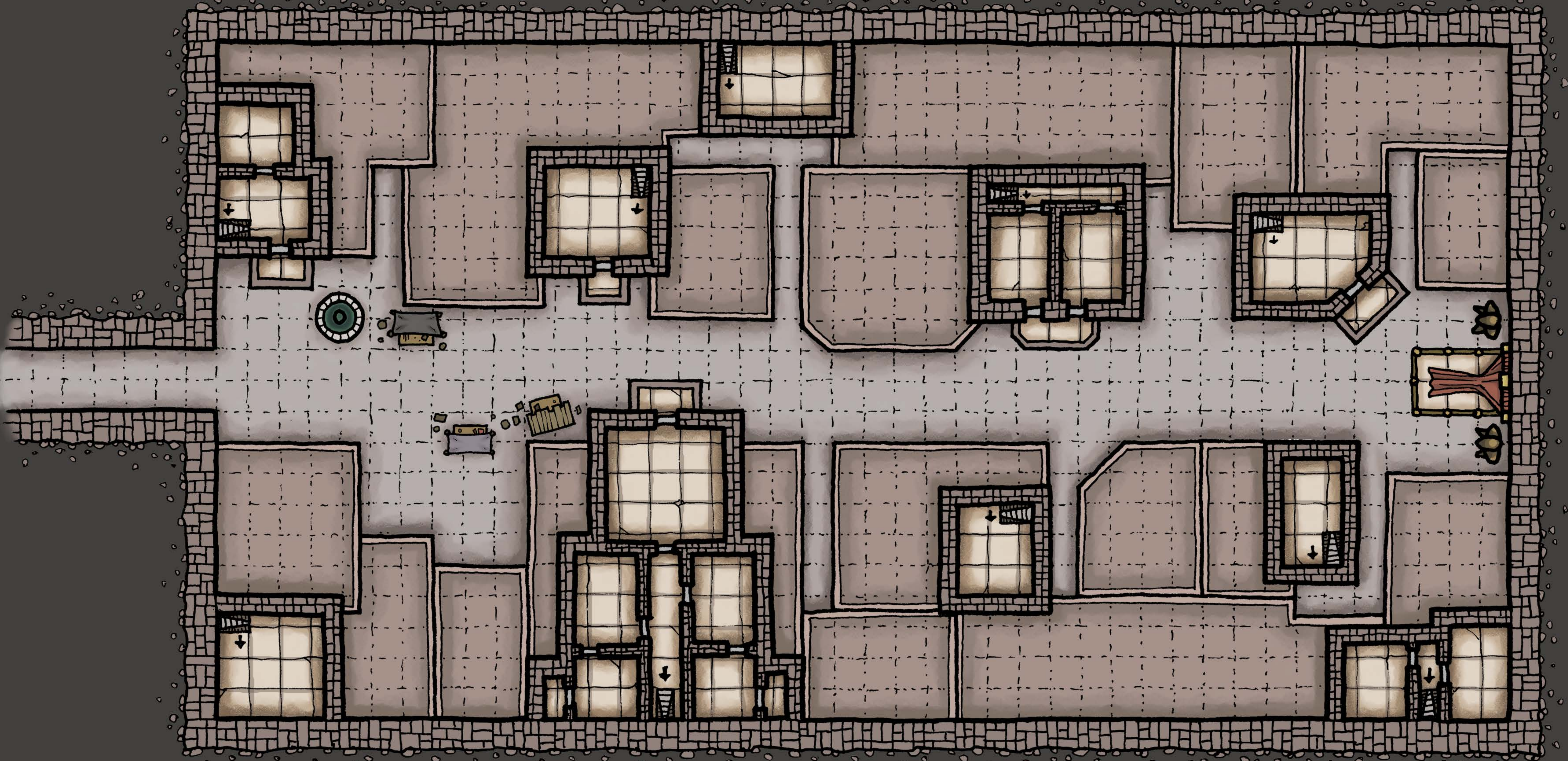

GROUND LEVEL

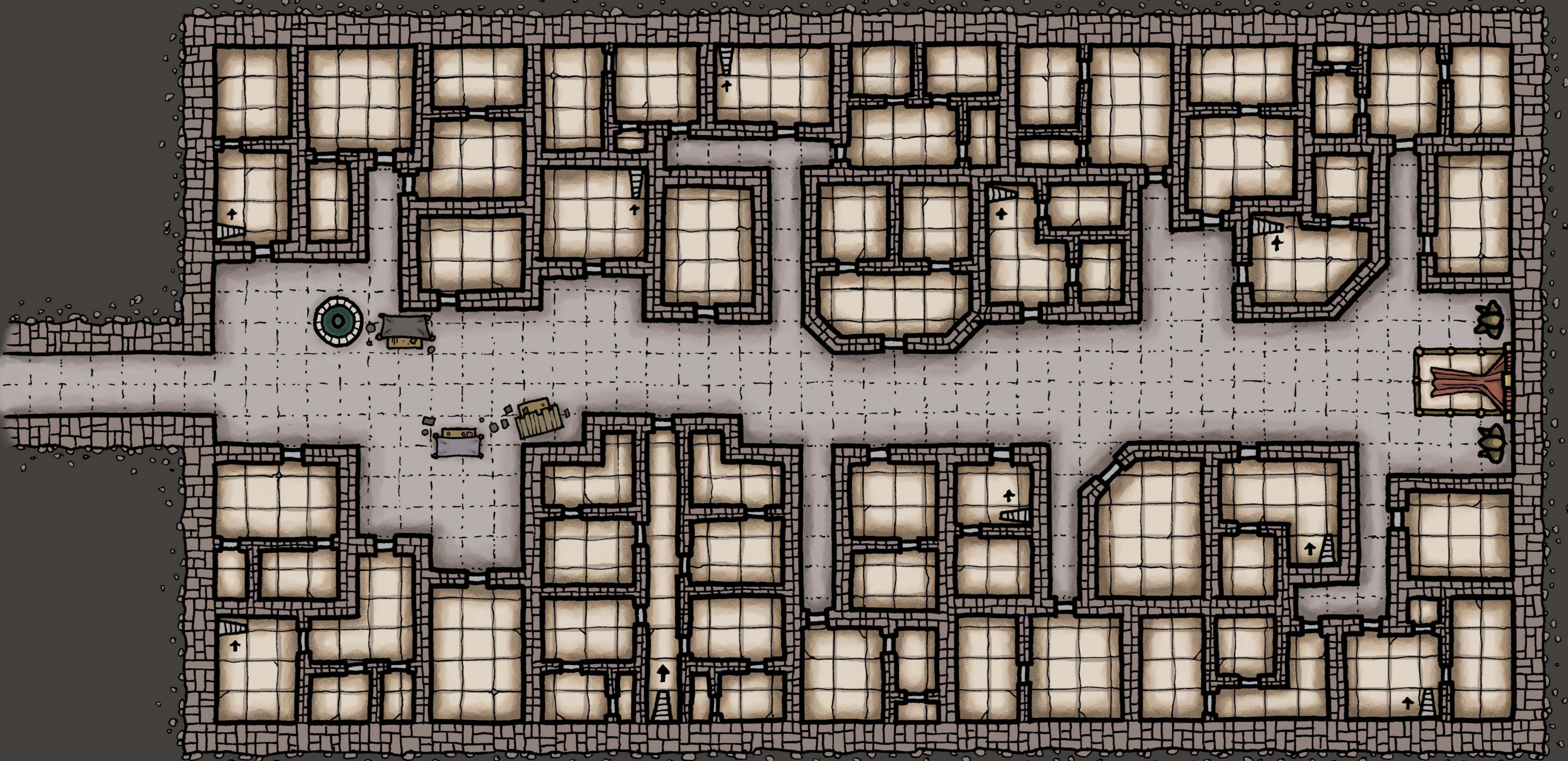

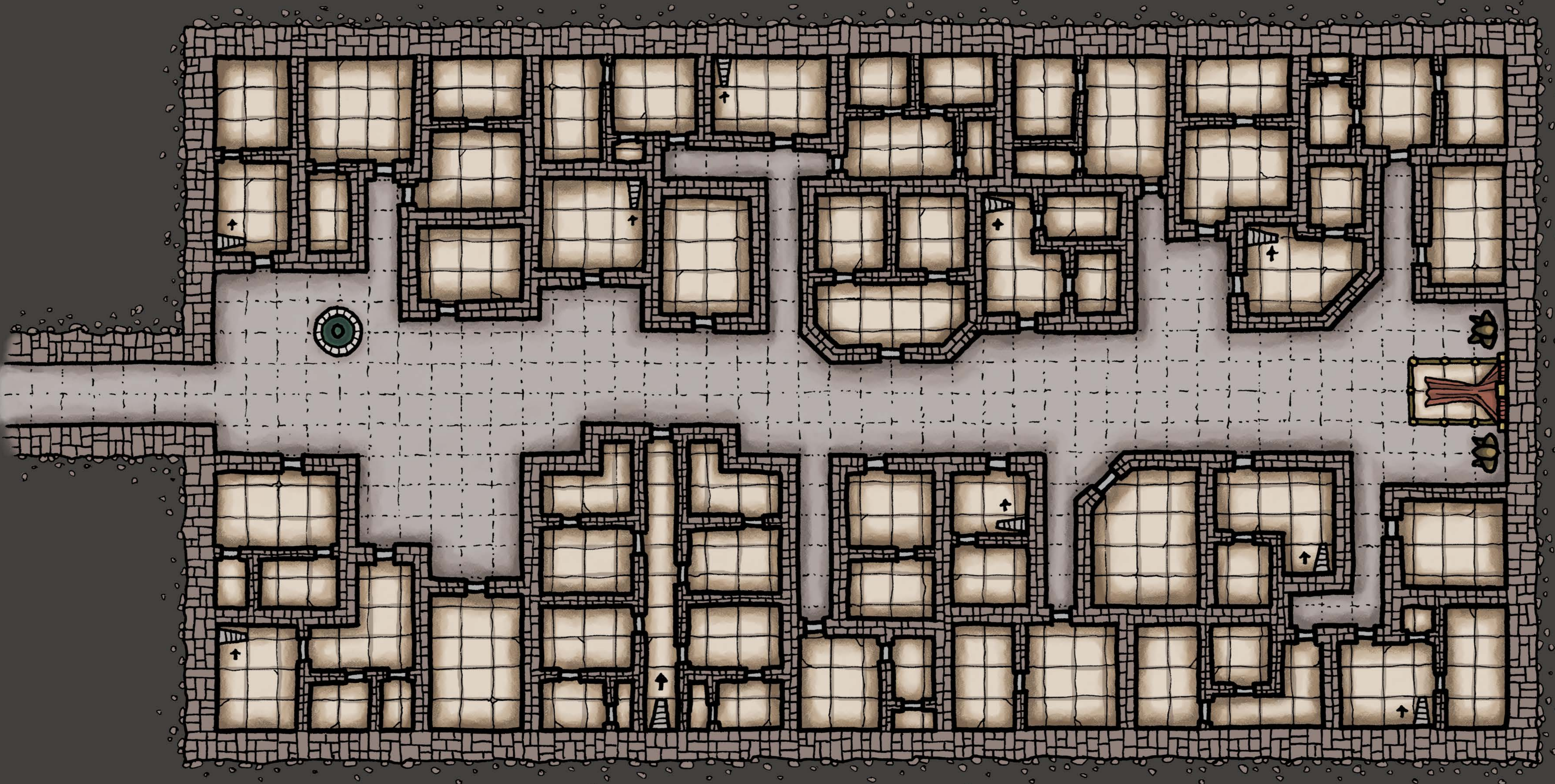
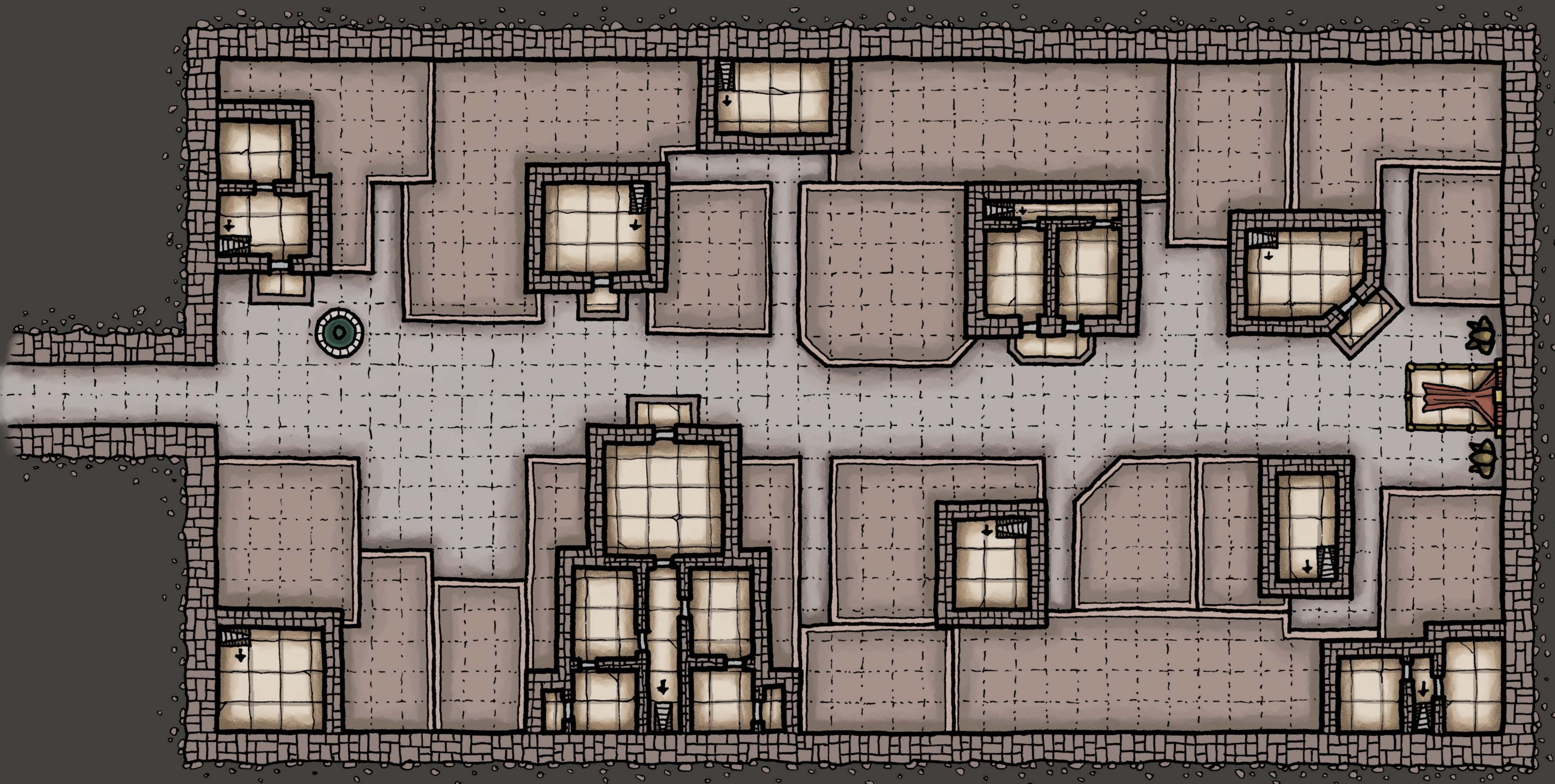

UPPER LEVEL

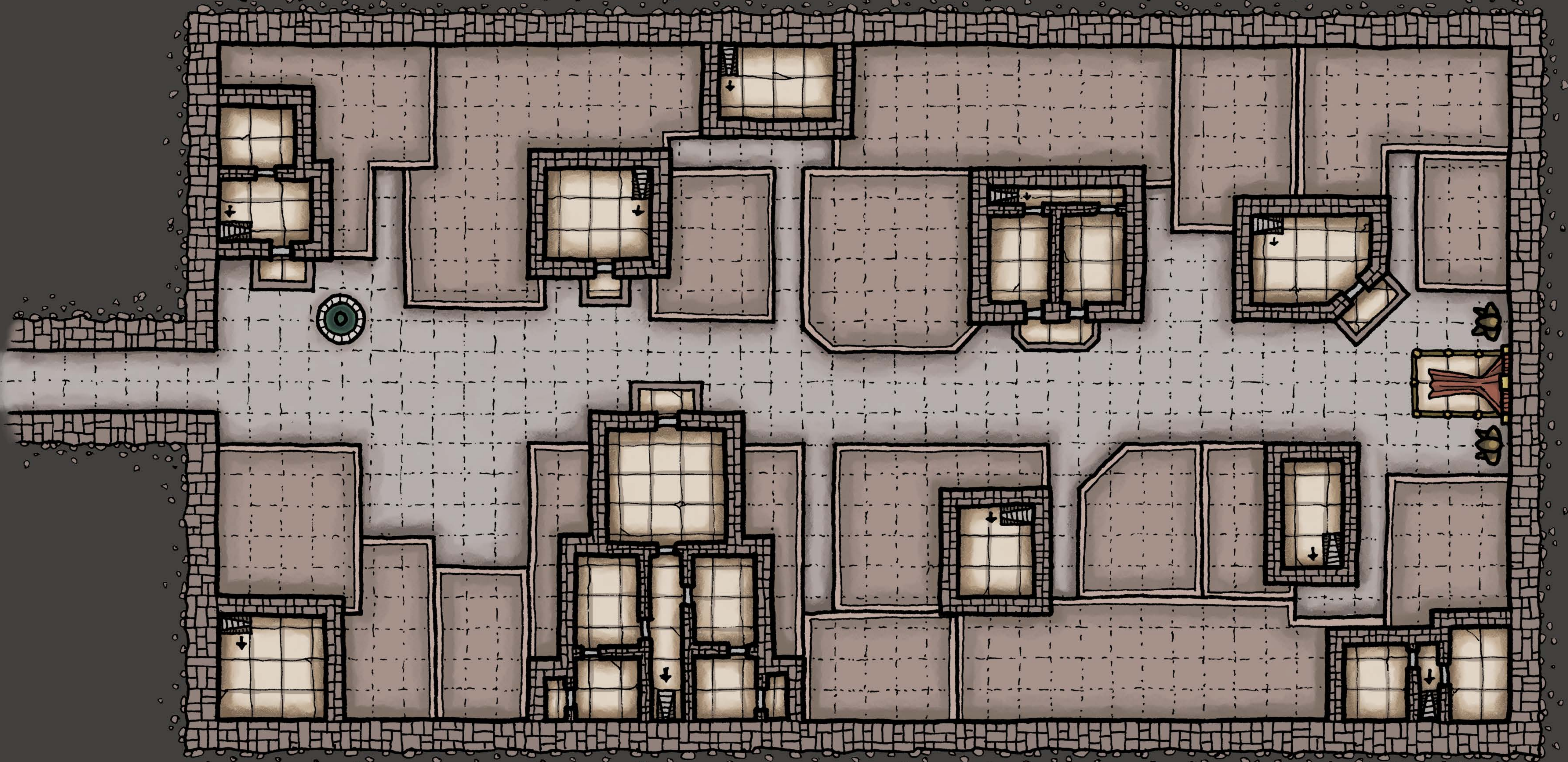

GROUND LEVEL

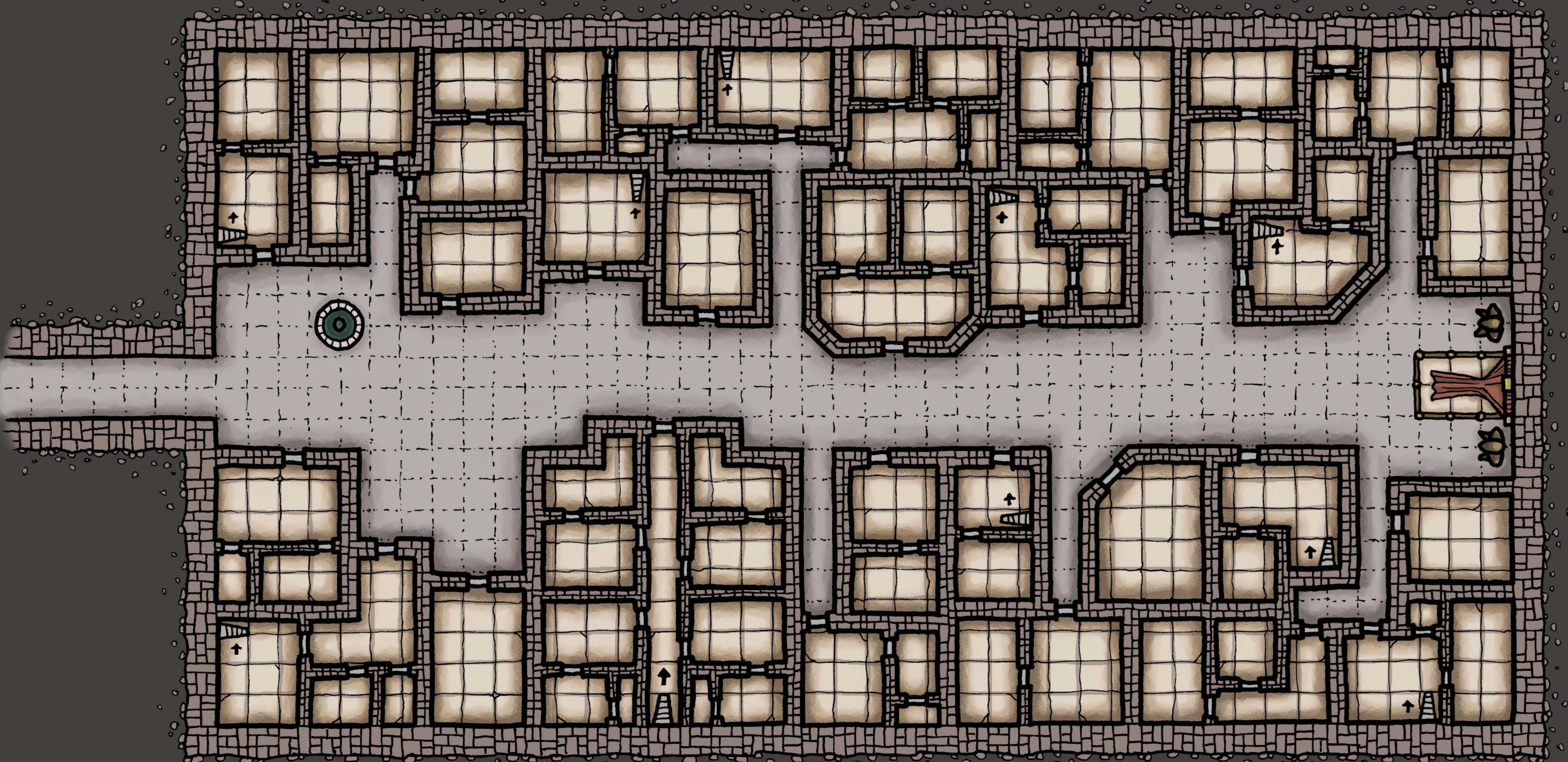

THE HALL OF THE LONG BANNER

UPPER LEVEL

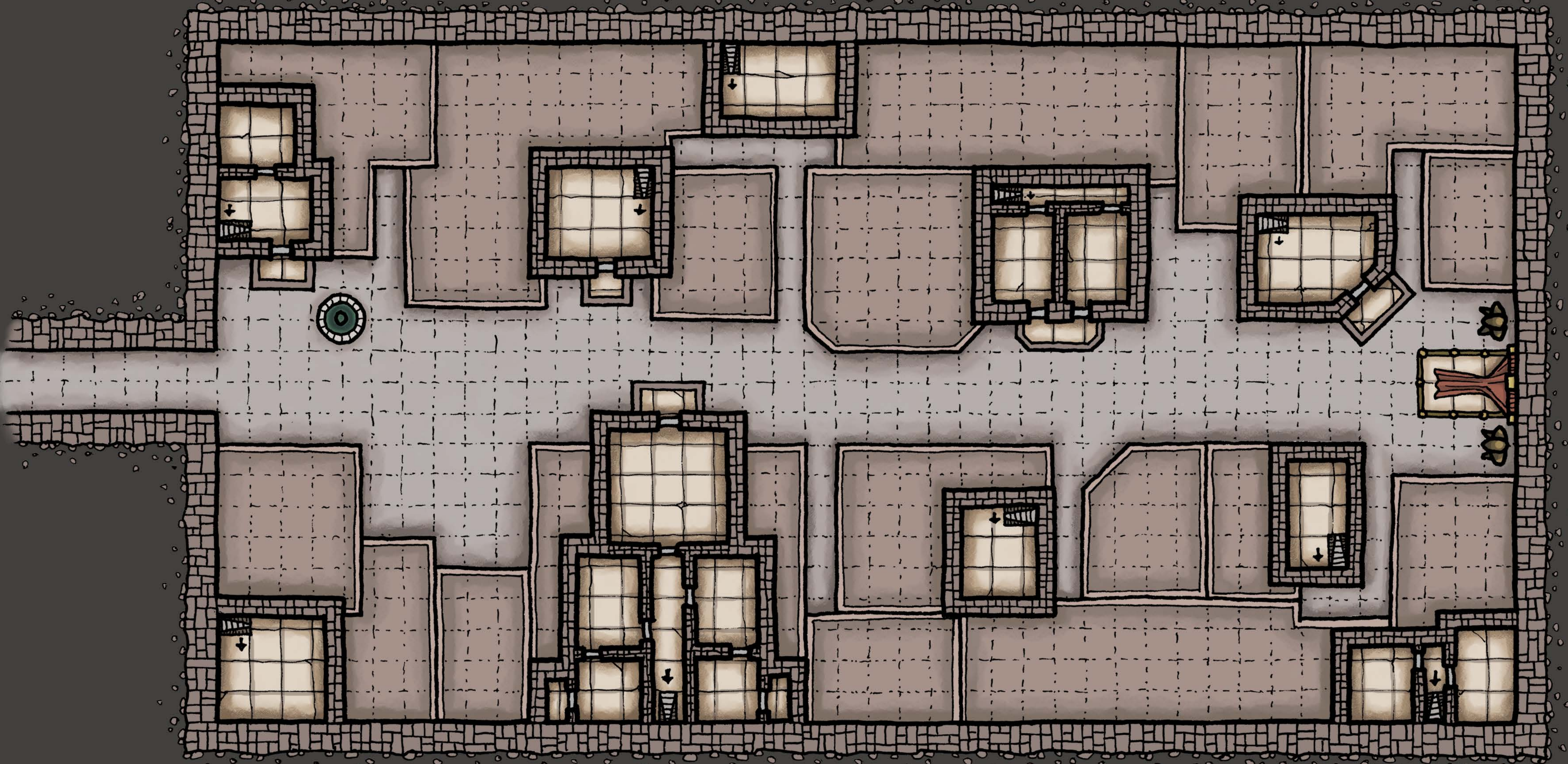

GROUND LEVEL

